

Orient Express

M241



| | |
|-----------------------------|--------------|
| Item no. M24170-3218P | |
| General Product Information | |
| Dimensions LxWxH | 122x72x93 cm |
| Age group | 6m+ |
| Play capacity (users) | 4 |
| Colour options | ● |



Wow! Children will delight in a ride on the Orient Express. This playful unit supports social-emotional and physical skills in young children. The intentional design encourages children to stay and play, which provides great fun and developmental benefits. In addition to being a place to sit alone or with friends, the Orient Express spurs stories about train rides,

supporting language skills and story-telling. Sitting with friends stimulates social-emotional development, and friendship skills. The small holes invite exploration and provide children with opportunities to play peek-a-boo and other games. Young children will also enjoy moving around the train, and for younger children, pulling themselves up to stand will support

physical development.



Orient Express

M241



Theme

Cognitive: suggests a theme and supports dramatic play, which stimulates language and communication skills.



Bench

Social-Emotional: gathering, cooperating or taking a break from play - all train social skills.

Orient Express

M241



Panels of 19mm EcoCore™. EcoCore™ is a highly durable, eco friendly material, which is not only recyclable after use, but also consists of material produced from +95% recycled post consumer material from food packing waste.



The seating area is made of HPL with a thickness 17,8 mm. KOMPAN HPL has high wearing strength to ensure long lifetime in all climates.

Item no. M24170-3218P

Installation Information

| | |
|--------------------------|--------------------------|
| Max. fall height | 35 cm |
| Safety surfacing area | 13.6 m² |
| Total installation time | 3.6 |
| Excavation volume | 0.13 m³ |
| Concrete volume | 0.00 m³ |
| Footing depth (standard) | 32 cm |
| Shipment weight | 103 kg |
| Anchoring options | In-ground ✓ Surface ✓ |

Warranty Information

| | |
|------------------------|----------|
| EcoCore HDPE | Lifetime |
| HPL seat | 15 years |
| Spare parts guaranteed | 10 years |



Sustainability Data

M241



| Cradle to Gate A1-A3 | Total CO ₂ emission | CO ₂ e/kg | Recycled materials |
|----------------------|--------------------------------|-------------------------|--------------------|
| | kg CO ₂ e | kg CO ₂ e/kg | % |
| M24170-3218P | 93.80 | 1.66 | 48.80 |

The overall framework applied for these factors is the Environmental Product Declaration (EPD), which quantifies "environmental information on the life cycle of a product and enable comparisons between products fulfilling the same function" (ISO, 2006). This follows the structure and applies a Life-Cycle Assessment approach to the entire Product stage from raw material through manufacturing (A1-A3))

* Max fall height | ** Total height | *** Safety surfacing area

* Max fall height | ** Total height

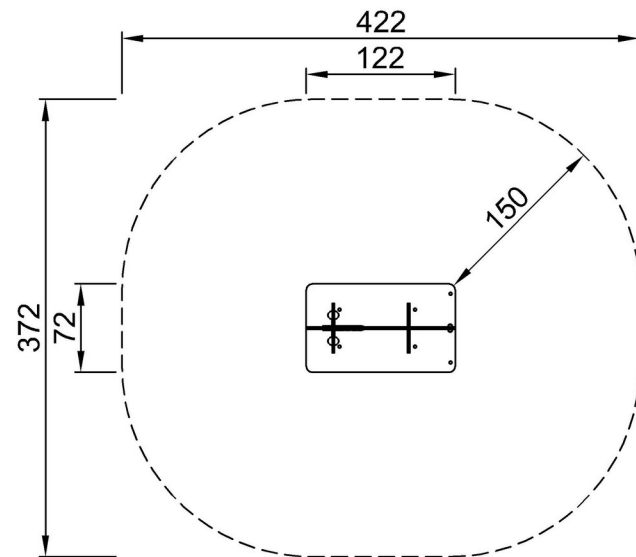

M24170P-xx18
*35cm
**93cm
***13.6m²

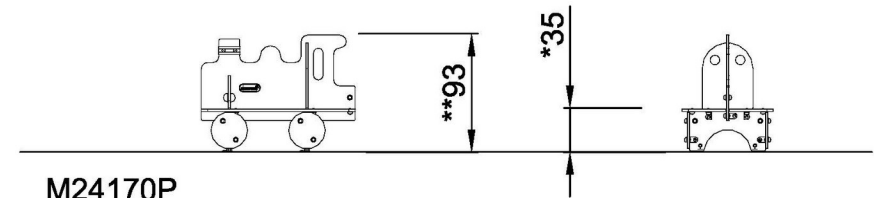

M24170P
1:100

[Click to see TOP VIEW](#)

[Click to see SIDE VIEW](#)