



# Dynamic Bar

NRO830



|                             |   |
|-----------------------------|---|
| Item no. NRO830-0901        |   |
| General Product Information |   |
| Dimensions LxWxH            | 211x18x145 cm   |
| Age group                   | 6+  |
| Play capacity (users)       | 1   |
| Colour options              |   |

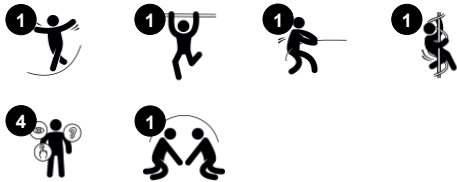

The Dynamic Bar is a fantastic playground thrill! It attracts all children, younger as well as older. The primary attraction is the responsiveness of the horizontal balance beam which moves as children walk on it. Holding onto the support rope, children are provided with a secure grip. This is an immense challenge for older children and spurs endless

competitions on who stays on the longest. This is great for cooperative skills and social-emotional development. Apart from being great fun, the Dynamic Bar is a true challenge for children's sense of balance. Children with a well-developed sense of balance have an easy time navigating the world confidently. They can sit still on a chair, and concentrate. Additionally,

children build bone density when they jump from the Dynamic Bar.



# Dynamic Bar

NRO830



## Rope handholds

**Physical:** provides stability in balancing. Makes possible hanging in arms, training upper body muscles. **Social-Emotional:** adds a feeling of security.



## Dynamic beam

**Physical:** the child practices balance intensely when staying on the spinning beam. This is a challenging and thrilling activity and develops the child's risk-taking skills in a safe and sound way, close to the ground. **Social-Emotional:** cooperation and consideration when spinning together with others.

# Dynamic Bar

NRO830



All organic Robinia products by KOMPAN are made of Robinia wood which is sourced from sustainable plantation farms. On request it can be supplied as FSC® Certified (FSC® C004450).



Nets and ropes are made of UV-stabilised PA with inner steel cable reinforcement. The rope is induction treated to create a strong connection between steel and rope, which leads to durable weather resistance.



The Robinia wood can be supplied as untreated raw wood or painted with a brown coloured transparent pigment that maintains the golden wood colour of the wood.

Item no. NRO830-0901

## Installation Information

|                          |                          |
|--------------------------|--------------------------|
| Max. fall height         | 44 cm                    |
| Safety surfacing area    | 14.4 m²                  |
| Total installation time  | 2.8                      |
| Excavation volume        | 0.23 m³                  |
| Concrete volume          | 0.00 m³                  |
| Footing depth (standard) | 90 cm                    |
| Shipment weight          | 123 kg                   |
| Anchoring options        | In-ground ✓<br>Surface ✓ |

## Warranty Information

|                            |          |
|----------------------------|----------|
| Robinia Wood               | 15 years |
| Ropes & Nets               | 10 years |
| Spare Parts Guarantee      | 10 years |
| Stainless Steel Components | Lifetime |



# Sustainability Data

NRO830



| Cradle to Gate A1-A3 | Total CO <sub>2</sub> emission | CO <sub>2</sub> e/kg    | Recycled materials |
|----------------------|--------------------------------|-------------------------|--------------------|
|                      | kg CO <sub>2</sub> e           | kg CO <sub>2</sub> e/kg | %                  |
| NRO830-0901          | 28.20                          | 0.31                    | 2.20               |

The overall framework applied for these factors is the Environmental Product Declaration (EPD), which quantifies "environmental information on the life cycle of a product and enable comparisons between products fulfilling the same function" (ISO, 2006). This follows the structure and applies a Life-Cycle Assessment approach to the entire Product stage from raw material through manufacturing (A1-A3))

**KOMPAN**  
Let's play

## Kompan A/S

C.F. Tietgens Boulevard 32C  
DK-5220 Odense SØ  
Denmark



## Verification of CO<sub>2</sub> calculation of: Nature play



Data version no. 2023-10-05

The CO<sub>2</sub> calculation and data are in compliance with the principles of a carbon footprint impact according to the GHG protocol (Greenhouse Gas Protocol), Scope 3, cradle to gate related to all individual components in the product category: "Nature play" represented by item no.: NRO409-0621.

(Scope 3 emissions include emission sources in the upstream and downstream value chain).

**Date: 30. October 2023 | Valid until: 30. October 2025**

**Verified by:**

Julie Marie Vejsgaard Larsen, LCA & EPD Consultant

Verification based on report: Validation of CO<sub>2</sub> calculation of 9 categories of Kompan product line, version 1.0, prepared by: Bureau Veritas HSE, Denmark: Julie M. V. Larsen.

**Publication date: 30. October 2023**

By Bureau Veritas HSE  
www.bureauveritas.dk  
+45 7731 1000



# Dynamic Bar

NRO830

\* Max fall height | \*\* Total height | \*\*\* Safety surfacing area

\* Max fall height | \*\* Total height

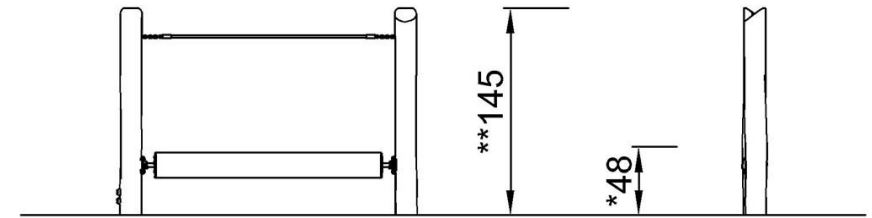
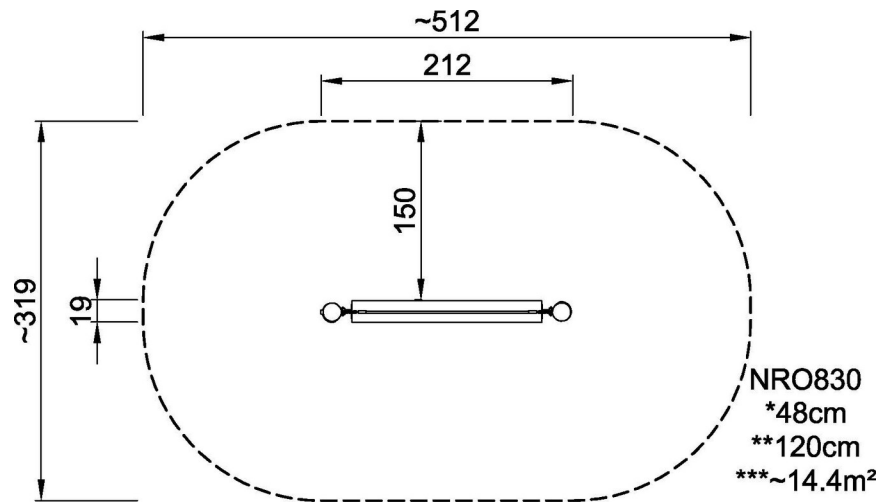

[Click to see TOP VIEW](#)

[Click to see SIDE VIEW](#)