

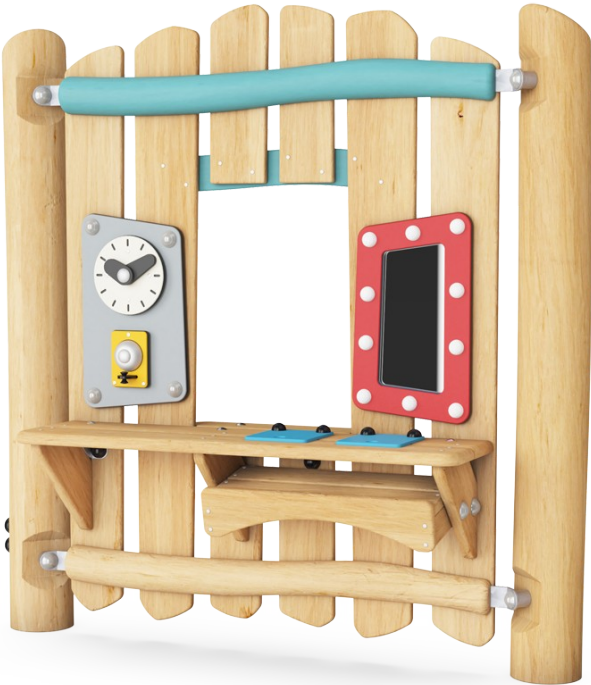

# Dress-Up Wall with Mirror

NRO603



The Robinia Dress-Up wall with Mirror is a great play creator that invites numerous play scenarios: shop, make-up parlour, kitchen, studio, to name a few. The table with covered holes and the shelf underneath make for endless play and experimenting, shifting materials through the holes. This stimulates the child's understanding of object permanence:

that things can disappear out of sight but still exist. The window, clock, mirror and bell invite hours of dramatic play, teaching creativity, imagination and socialising. The Robinia timber also provides an organic structure, that the children can touch and feel, observing how natural materials interact with the environment

Item no. NRO603-1021	
General Product Information	
Dimensions LxWxH	150x17x151 cm
Age group	1+
Play capacity (users)	6
Colour options	

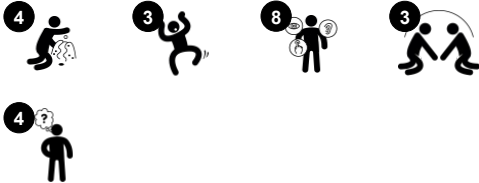

# Dress-Up Wall with Mirror

NRO603



## Mirror

**Cognitive:** understanding of individuality and self expression. Stimulates dramatic play, language and communication skills..

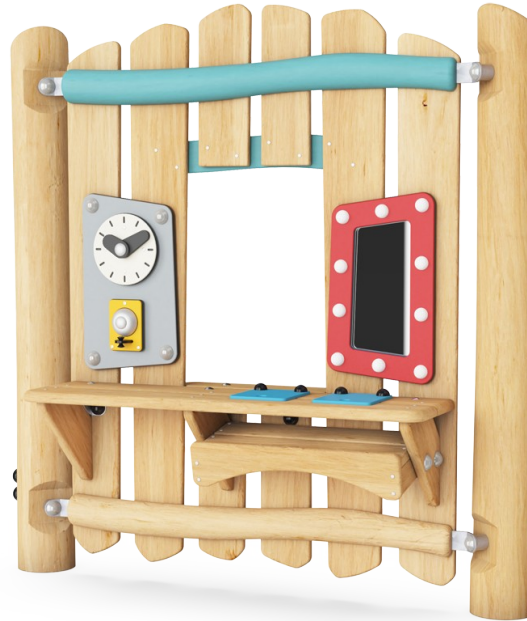

## Shelf

**Cognitive:** suggests a theme and supports dramatic play, which stimulates languages and communication skills. Gives the option of dramatic or explorative play.



## Desk flaps w. holes

**Social-Emotional:** cooperation, turn-taking and parallel play inspired by the two flaps.

**Cognitive:** shifting things through holes to shelf supports logical thinking and understanding of object permanence.



## Window

**Social-Emotional:** invites interaction between sides and cooperative play.



## Clock and bell panel

**Cognitive:** understanding cause and effect when ringing bell, learning about numeracy and time in a tangible way. **Creative:** creating new positions on clock or with sound creating a rhythm when ringing or knocking the bell.

# Dress-Up Wall with Mirror

NRO603



All organic Robinia products by KOMPAN are made of Robinia wood which is sourced from sustainable plantation farms. On request it can be supplied as FSC® Certified (FSC® C004450).



The paint used for coloured components is water-based, which is environmentally friendly and has excellent UV resistance. The paint is compliant with Australian Standards.



Play activities are manufactured in high impact resistant materials. This includes; HDPE-plate with HDPE-clock with conveyor belt rubber hands, the bell in pressed aluminium and mirror in plexiglass with a high impact resistant.

Item no. NRO603-1021

## Installation Information

Max. fall height	0 cm
Safety surfacing area	12.7 m²
Total installation time	5.5
Excavation volume	0.25 m³
Concrete volume	0.00 m³
Footing depth (standard)	100 cm
Shipment weight	152 kg
Anchoring options	In-ground ✓

## Warranty Information

Robinia Wood	15 years
Spare Parts Guarantee	10 years
Stainless Steel Components	Lifetime
Stainless Steel Components	Lifetime



All rubber activities/components are made of conveyor belt rubber; making it extremely durable and weather resistant.



The percussion panel consists of two Conga Drums with PP tubes and top in coloured ABS. Babel drum in stainless steel 316L.

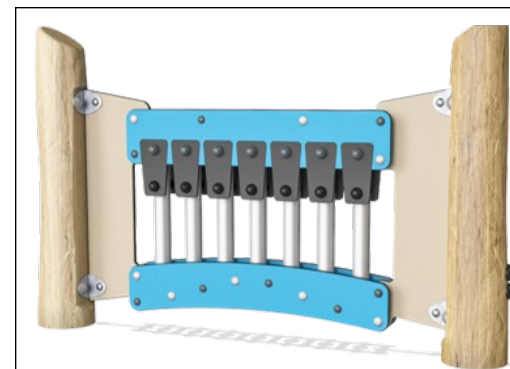

The Xylofon music panel consists of HDPE - material in 19mm EcoCore™. EcoCore™ is a highly durable, eco-friendly material. The pipes are made of die-cast aluminium specifically alloyed for outdoor environments.



# Sustainability Data

NRO603

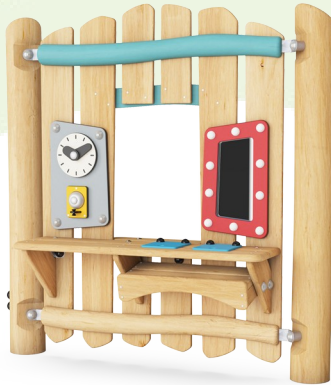

Cradle to Gate A1-A3	Total CO <sub>2</sub> emission	CO <sub>2</sub> e/kg	Recycled materials
	kg CO <sub>2</sub> e	kg CO <sub>2</sub> e/kg	%
NRO603-1021	36.50	0.30	5.20

The overall framework applied for these factors is the Environmental Product Declaration (EPD), which quantifies "environmental information on the life cycle of a product and enable comparisons between products fulfilling the same function" (ISO, 2006). This follows the structure and applies a Life-Cycle Assessment approach to the entire Product stage from raw material through manufacturing (A1-A3))

**KOMPAN**  
Let's play

## Kompan A/S

C.F. Tietgens Boulevard 32C  
DK-5220 Odense SØ  
Denmark



## Verification of CO<sub>2</sub> calculation of: Nature play



Data version no. 2023-10-05

The CO<sub>2</sub> calculation and data are in compliance with the principles of a carbon footprint impact according to the GHG protocol (Greenhouse Gas Protocol), Scope 3, cradle to gate related to all individual components in the product category: "Nature play" represented by item no.: NRO409-0621.

(Scope 3 emissions include emission sources in the upstream and downstream value chain).

**Date: 30. October 2023 | Valid until: 30. October 2025**

**Verified by:**

Julie Marie Vejsgaard Larsen, LCA & EPD Consultant

Verification based on report: Validation of CO<sub>2</sub> calculation of 9 categories of Kompan product line, version 1.0, prepared by: Bureau Veritas HSE, Denmark: Julie M. V. Larsen.

**Publication date: 30. October 2023**

By Bureau Veritas HSE  
www.bureauveritas.dk  
+45 7731 1000





# Dress-Up Wall with Mirror

NRO603

\* Max fall height | \*\* Total height | \*\*\* Safety surfacing area

\* Max fall height | \*\* Total height

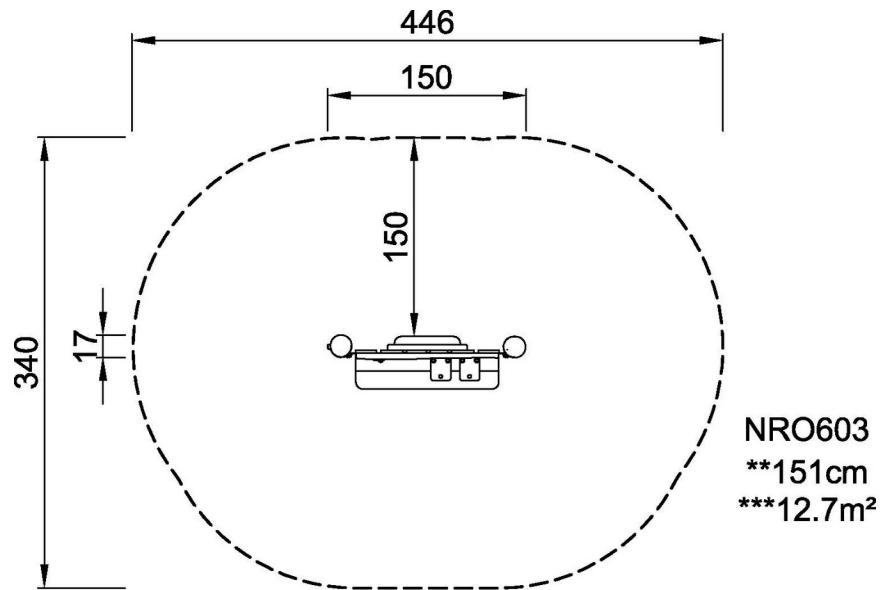

[Click to see TOP VIEW](#)

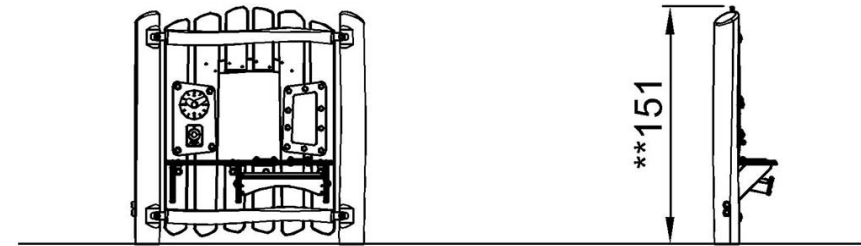

NRO603

[Click to see SIDE VIEW](#)