

# Splash Table

NRO506

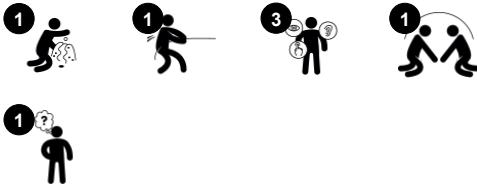

产品编号 NRO506-0601	
产品信息概览	
长宽高尺寸	115x115x62 cm
适用年龄段	2+
容纳人数	8
颜色选择	 



The Splash Table is a favorite play item that children are repeatedly attracted to. It makes a great gathering point for explorative play: sand play, water play and general sharing of found items. Sand and water play is a popular activity that can keep children playing for hours. The rubber plug can be pulled up to let water stream out of the table or let go to keep water

in the basin. This trains the child's understanding of cause and effect. For younger children, it stimulates their understanding of object permanence: that materials still exists even though they go out of sight. Children can be gathered on all sides of the table. This supports cooperation, negotiation and communication, all fundamental in the child's

social-emotional development.



# Splash Table

NRO506



## Splash table with plug

**社交情感**：meeting point for cooperation and sharing. Develops turn-taking and cooperation. **认知能力**：当孩子们停止游戏或放开盆中的水时，可以训练逻辑思维和对因果关系的理解。 **创造力**：the water plug makes changing water levels possible, which adds to logical thinking skills.



# Splash Table

NRO506



KOMPAN 的所有有机刺槐产品均由 刺槐木材制成，来自欧洲的可持续环保木材。可根据要求提供 FSC® Certified (FSC® C004450)

刺槐产品有三种不同的木材处理选项：未经处理的刺槐木或棕褐色涂有颜料的颜料，可保持木材的颜色，并使用选定成分的涂料着色。

**KOMPAN**  
Let's play

产品编号 NRO506-0601

## 安装信息

最大跌落高度	0 cm
安全面积	15.2 m²
安装总时长	2.7
开挖量	0.17 m³
混凝土使用量	0.00 m³
标准入地深度	60 cm
运输重量	125 kg
固定选项	入地 ✓
	地表 ✓

## 质保信息

Robinia 木材	15 年
承保零部件	10 年
不锈钢零件	终身质保



# Sustainability Data

NRO506



从原材料到成品	CO <sub>2</sub> 排放总量	CO <sub>2</sub> 排放量 / 千克	回收的原料
	kg CO <sub>2</sub> e	kg CO <sub>2</sub> e/kg	%
NRO506-0601	80.10	0.81	8.70

这些因素采用的总体框架为环保产品声明 (EPD)，该声明可量化“产品生命周期的环保信息，并对相同功能的产品进行对比” (ISO, 2006)。在遵循该框架的同时，对从原材料到制造的整个产品阶段 (A1-A3) 应用生命周期评估法。

**KOMPAN**  
Let's play

## Kompan A/S

C.F. Tietgens Boulevard 32C  
DK-5220 Odense SØ  
Denmark



## Verification of CO<sub>2</sub> calculation of: Nature play



Data version no. 2023-10-05

The CO<sub>2</sub> calculation and data are in compliance with the principles of a carbon footprint impact according to the GHG protocol (Greenhouse Gas Protocol), Scope 3, cradle to gate related to all individual components in the product category: "Nature play" represented by item no.: NRO409-0621.

(Scope 3 emissions include emission sources in the upstream and downstream value chain).

**Date: 30. October 2023 | Valid until: 30. October 2025**

**Verified by:**

Julie Marie Vejsgaard Larsen, LCA & EPD Consultant

Verification based on report: Validation of CO<sub>2</sub> calculation of 9 categories of Kompan product line, version 1.0, prepared by: Bureau Veritas HSE, Denmark: Julie M. V. Larsen.

**Publication date: 30. October 2023**

By Bureau Veritas HSE  
www.bureauveritas.dk  
+45 7731 1000



# Splash Table

NRO506

最大跌落高度 | 总高度 | 安全区域

最大跌落高度 | 总高度

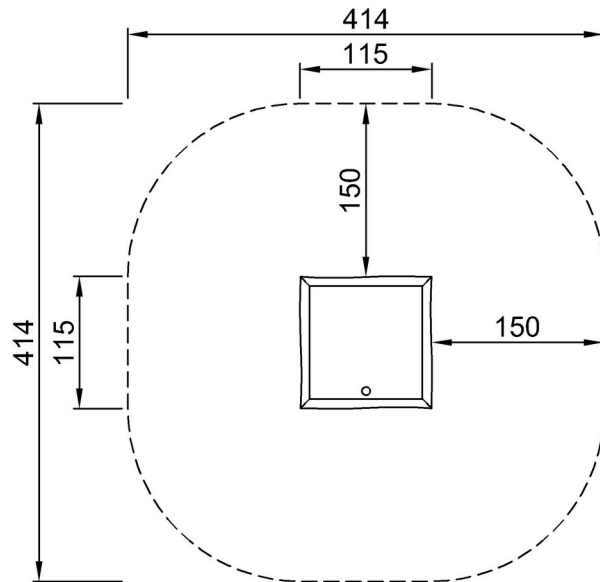

NRO506-xx01  
\*0cm  
\*\*62cm  
\*\*\*15.2m<sup>2</sup>

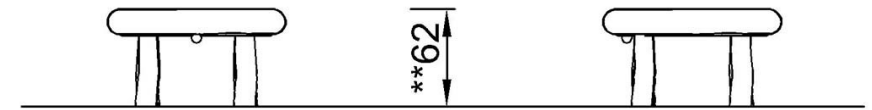

NRO506

[点击查看俯视图](#)

[点击查看侧面图](#)