

# Play Panel 1 - Creative

PCM000621

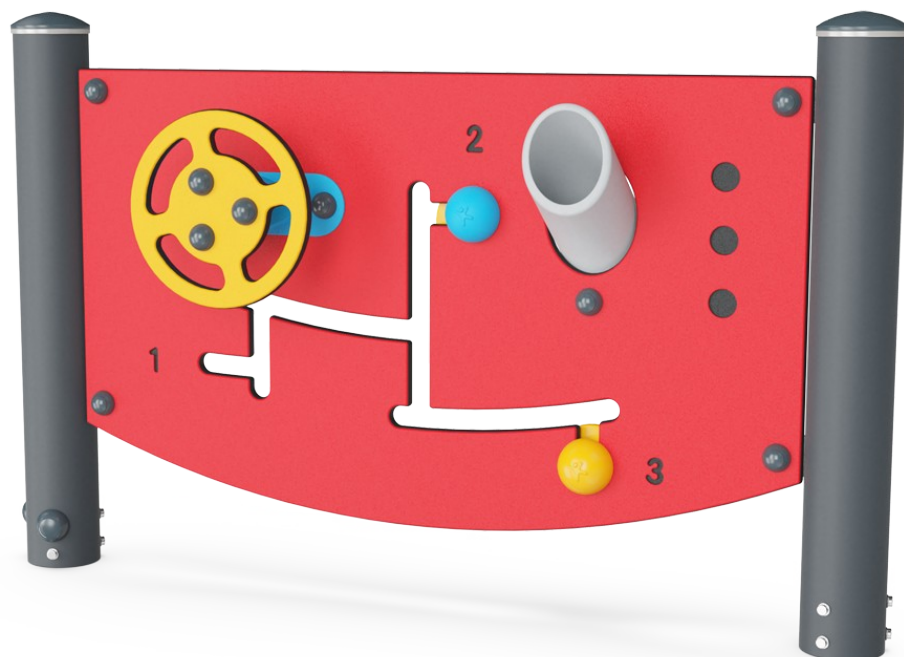

Item no. PCM000621-0901	
General Product Information	
Dimensions LxWxH	121x28x75 cm
Age group	1+
Play capacity (users)	4
Colour options	

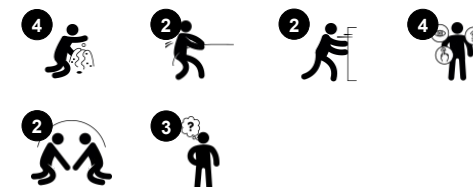

Wow! The children can't keep their hands off the Manipulative Play Panel. The variation of responsive play elements inspires exploration. The wide panel and the fact that all items on one side are connected to action on the other side support cause and effect understanding as well as cooperation and turn-taking in social play. The feedback to the child's actions is

important to logical thinking: The steering wheel moves another wheel. The play spheres with numbers move play shovels on the other side. The funnel turns up on one side, and down on the other. This invites infants and children to run items or sand through, a favourite pastime which stimulates object permanence, understanding that items and

people don't cease to exist when out of sight. The shovels can be placed to catch and transport sand in creative play.



# Play Panel 1 - Creative

PCM000621



## Gearshift and tube panel

**Social-Emotional:** spurs group play and conversations with its two-sidedness.

**Cognitive:** supports dramatic play, which stimulates language skills. Communication skills when explaining functionalities. The passing of materials through funnels supports the children's logical thinking and the understanding of object permanence.

**Creative:** changing the position of the gear, leaving your mark.

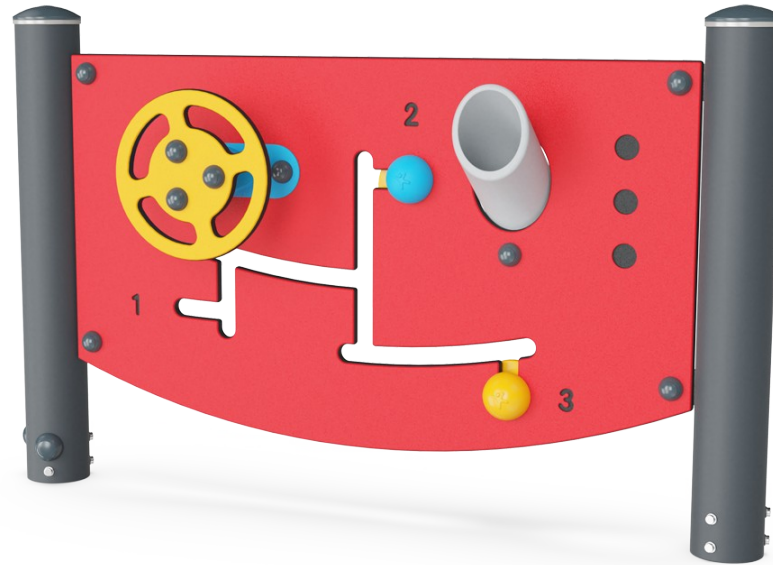

# Play Panel 1 - Creative

PCM000621

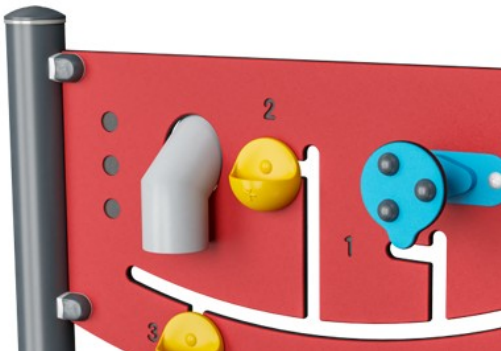
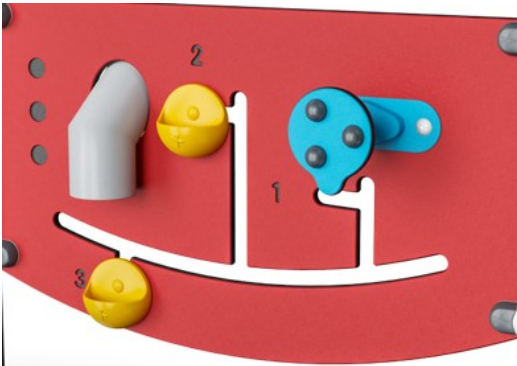

Panels of 19mm EcoCore™. EcoCore™ is a highly durable, eco-friendly material, which is not only recyclable after use but also consists of a core produced from 100% recycled material.

Main posts with hot dip galvanized steel footing are available in different materials: Pressure impregnated pine wood posts. Pre-galvanized inside and outside with powder coated top finish steel posts. Lead free aluminum with color anodized top finish. Greenline TexMade posts of 95% post-consumer recycled PE and textile waste.

Play activities like the funnel are manufactured from injection moulded high-quality nylon (PA6) which has good wearing and impact strength and is UV stabilised.

Item no. PCM000621-0901	
Installation Information	
Max. fall height	0 cm
Safety surfacing area	11.1 m²
Total installation time	3.6
Excavation volume	0.05 m³
Concrete volume	0.00 m³
Footing depth (standard)	85 cm
Shipment weight	45 kg
Anchoring options	In-ground ✓ Surface ✓
Warranty Information	
EcoCore HDPE	Lifetime
Galvanised Steel	Lifetime
Movable Parts	2 years
Post	10 years
Spare Parts Guarantee	10 years



KOMPAN GreenLine versions are designed with ultimate environmentally friendly materials with the lowest possible CO2e emission factor such as EcoCore™ panels of 100% post consumer recycled ocean waste.



# Sustainability Data

PCM000621

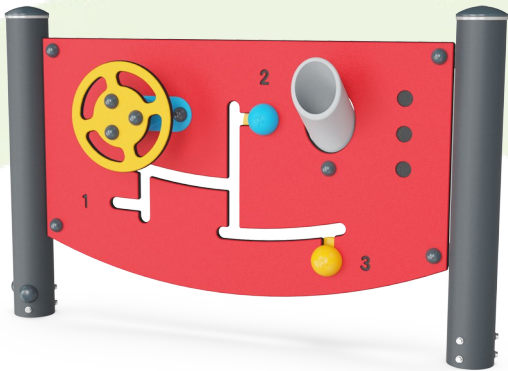

Cradle to Gate A1-A3	Total CO <sub>2</sub> emission	CO <sub>2</sub> e/kg	Recycled materials
	kg CO <sub>2</sub> e	kg CO <sub>2</sub> e/kg	%
PCM000621-0950	74.20	2.06	69.10
PCM000621-0901	82.80	2.59	58.50

The overall framework applied for these factors is the Environmental Product Declaration (EPD), which quantifies "environmental information on the life cycle of a product and enable comparisons between products fulfilling the same function" (ISO, 2006). This follows the structure and applies a Life-Cycle Assessment approach to the entire Product stage from raw material through manufacturing (A1-A3))

# Play Panel 1 - Creative

PCM000621

\* Max fall height | \*\* Total height | \*\*\* Safety surfacing area

\* Max fall height | \*\* Total height

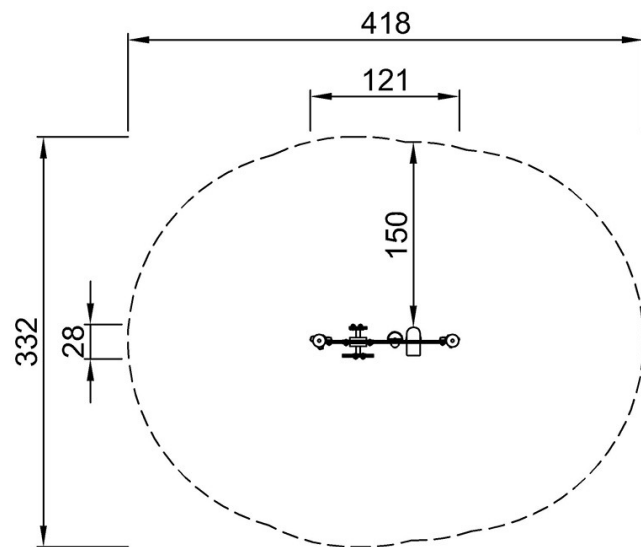

PCM000621

\*\*75cm

\*\*\*11.1m<sup>2</sup>



PCM000621

[Click to see TOP VIEW](#)

[Click to see SIDE VIEW](#)