

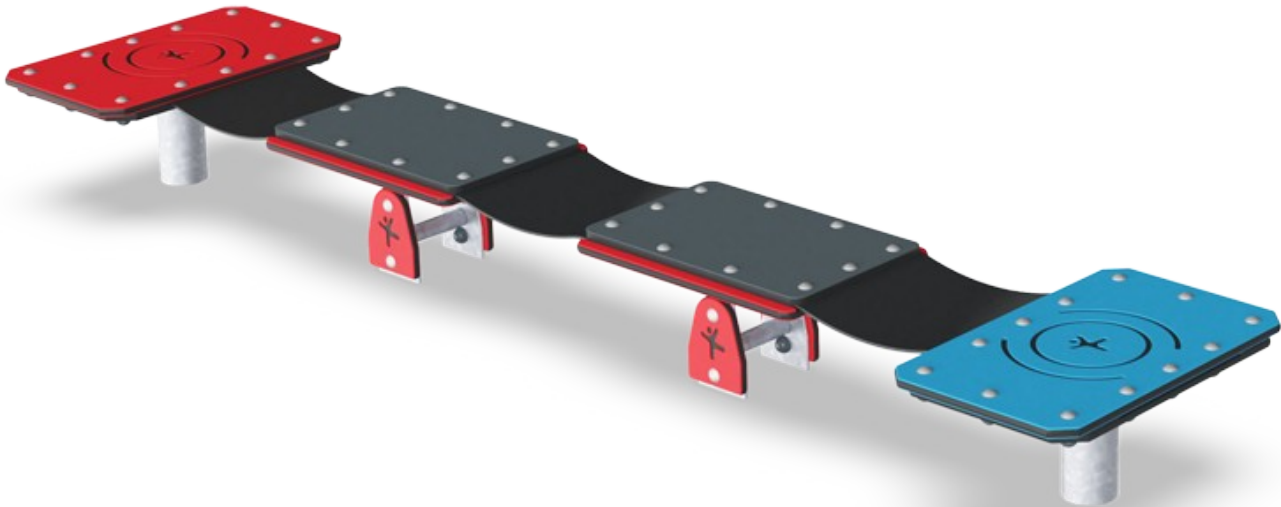



Wave Stepper

CRP201201



Item no. CRP201201-0401	
General Product Information	
Dimensions LxWxH	290x65x29 cm
Age group	2+
Play capacity (users)	4
Colour options	  



The Wave Stepper is a great balancing quest, attracting children and encouraging them to play again and again. Response to the children's movement provides thrill and develops the cause-and-effect understanding; when I move here, the bridge responds with this movement. When walking or running across the Wave Stepper, the children train

their sense of balance, which is a fundamental motor skill and basic for the development of all other skills. The sense of balance for instance makes it possible for children to sit still and concentrate. When children play together on the Wave Stepper, they develop empathy, turn-taking skills, and consideration. The 360-degree design allows for social interaction for

all at ground level.



Wave Stepper

CRP201201

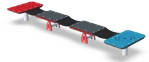

Wave Stepper

Physical: trains the sense of balance, fundamental for all other motor skills. This builds children's ability to navigate their bodies confidently and securely through the world.

Social-Emotional: turn-taking skills and negotiation when crossing each other and seating, standing, jumping.

Cognitive: supports cause-and-effect understanding when the steps slightly tilt in accordance with the children's movements.



Wave Stepper

CRP201201



Corocord membranes consist of friction-proof rubberized material of conveyor belt quality with excellent UV resistance. Tested and compliant with REACH requirements for PAH. Embedded is a four-layered armouring made of woven polyester. The armouring and the two surface layers result in a total thickness of 8 mm.

Panels of 19mm EcoCore™. EcoCore™ is a highly durable, eco friendly material, which is not only recyclable after use, but also consists of material produced from +95% recycled post consumer material from food packing waste.

The two central plates on the Wave Stepper are of made of Ekogrip® panels that consist of a 15mm thick PE base with 3 mm top-layer of soft rubber with a non-skid effect.



The bushings are made of stainless steel or galvanized steel to ensures excellent shock absorption and durable connections with a high corrosion resistance.

The steel surfaces are hot dip galvanized inside and outside with lead free zinc. The galvanisation has excellent corrosion resistance in outside environments and requires low maintenance.

The Wave Stepper comes in three different iconic color concepts. But the Stepper can also be customized to your preferences and personalized with a variety of Kompan colors, for both the base plates and footing.

Item no. CRP201201-0401	
Installation Information	
Max. fall height	28 cm
Safety surfacing area	19.3 m²
Total installation time	4.9
Excavation volume	1.73 m³
Concrete volume	0.96 m³
Footing depth (standard)	90 cm
Shipment weight	132 kg
Anchoring options	In-ground ✓
Warranty Information	
EcoCore HDPE	Lifetime
Hot dip galvanised steel	Lifetime
Membrane	2 years
Movable parts	2 years
Spare parts guaranteed	10 years

**EN
1176**
compliant

Sustainability Data

CRP201201

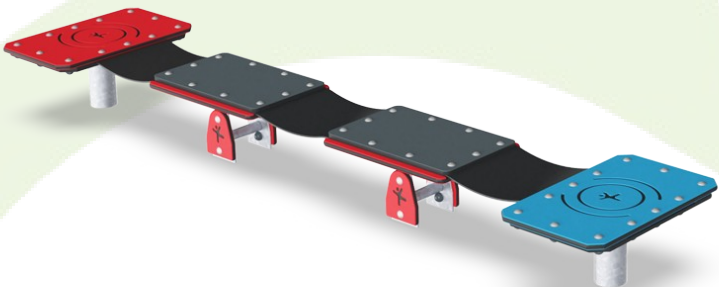

Cradle to Gate A1-A3	Total CO ₂ emission	CO ₂ e/kg	Recycled materials
	kg CO ₂ e	kg CO ₂ e/kg	%
CRP201201-0401	233.40	2.33	57.10

The overall framework applied for these factors is the Environmental Product Declaration (EPD), which quantifies "environmental information on the life cycle of a product and enable comparisons between products fulfilling the same function" (ISO, 2006). This follows the structure and applies a Life-Cycle Assessment approach to the entire Product stage from raw material through manufacturing (A1-A3))

Kompan A/S
C.F. Tietgens Boulevard 32C
DK-5220 Odense SØ
Denmark



Verification of CO₂ calculation of: Corocord



Data version no. 2023-10-05

The CO₂ calculation and data are in compliance with the principles of a carbon footprint impact according to the GHG protocol (Greenhouse Gas Protocol), Scope 3, cradle to gate related to all individual components in the product category: "Corocord" represented by item no.: COR314011-1101.

(Scope 3 emissions include emission sources in the upstream and downstream value chain).

Date: 30. October 2023 | Valid until: 30. October 2025
Verified by:

Julie Marie Vejsgaard Larsen, LCA & EPD Consultant

Verification based on report: Validation of CO₂ calculation of 9 categories of Kompan product line, version 1.0, prepared by: Bureau Veritas HSE, Denmark: Julie M. V. Larsen.

Publication date: 30. October 2023

By Bureau Veritas HSE
www.bureauveritas.dk
+45 7731 1000



Wave Stepper

CRP201201

* Max fall height | ** Total height | *** Safety surfacing area

* Max fall height | ** Total height

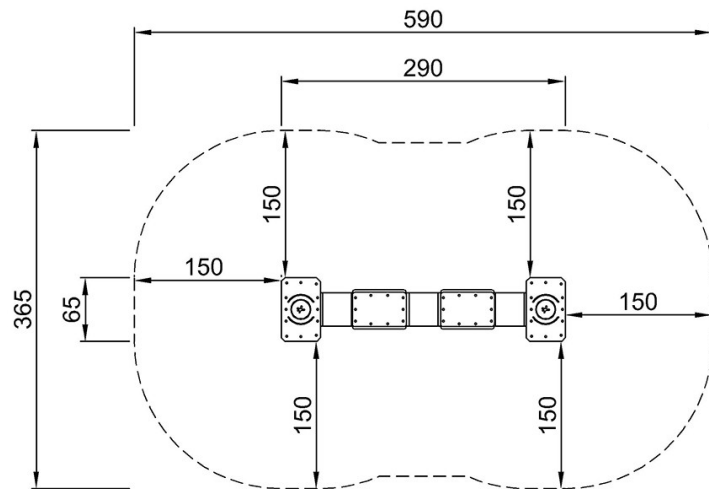

CRP201201
*28cm
**29cm
***19.3m²

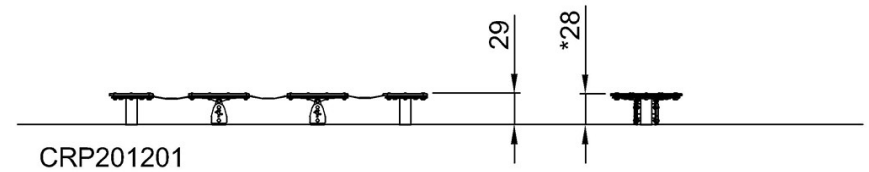

[Click to see TOP VIEW](#)

[Click to see SIDE VIEW](#)