



Sitting Pole

NRO210



An elegant piece of Robinia timber to play on or sit on to take a rest. It can also be used as a connector between other pieces or a meeting post, in fun playground games.

| | |
|-----------------------------|---|
| Item no. NRO210-0501 | |
| General Product Information | |
| Dimensions LxWxH | 27x22x29 cm |
| Age group | 1+ |
| Play capacity (users) | 1 |
| Colour options |   |



Sitting Pole

NRO210



Pole seats

Physical: balancing and jumping from one seat to the next trains balance, proprioception and builds bone density. **Social-Emotional:** sharing, listening when having a break.



Sitting Pole

NRO210



All organic Robinia products by KOMPAN are made of Robinia wood which is sourced from sustainable plantation farms. On request it can be supplied as FSC® Certified (FSC® C004450).

| | |
|--------------------------|-------------|
| Item no. NRO210-0501 | |
| Installation Information | |
| Max. fall height | 29 cm |
| Safety surfacing area | 8.5 m² |
| Total installation time | 0.9 |
| Excavation volume | 0.07 m³ |
| Concrete volume | 0.00 m³ |
| Footing depth (standard) | 52 cm |
| Shipment weight | 16 kg |
| Anchoring options | In-ground ✓ |
| | Surface ✓ |
| Warranty Information | |
| Robinia Wood | 15 years |
| Spare Parts Guarantee | 10 years |



Sustainability Data

NRO210



Cradle to Gate A1-A3

Total CO₂ emission

CO₂e/kg

Recycled materials

kg CO₂e

kg CO₂e/kg

%

NRO210-0501

2.10

0.16

0.30

The overall framework applied for these factors is the Environmental Product Declaration (EPD), which quantifies "environmental information on the life cycle of a product and enable comparisons between products fulfilling the same function" (ISO, 2006). This follows the structure and applies a Life-Cycle Assessment approach to the entire Product stage from raw material through manufacturing (A1-A3))

Kompan A/S

C.F. Tietgens Boulevard 32C
DK-5220 Odense SØ
Denmark



Verification of CO₂ calculation of: Nature play



Data version no. 2023-10-05

The CO₂ calculation and data are in compliance with the principles of a carbon footprint impact according to the GHG protocol (Greenhouse Gas Protocol), Scope 3, cradle to gate related to all individual components in the product category: "Nature play" represented by item no.: NRO409-0621.

(Scope 3 emissions include emission sources in the upstream and downstream value chain).

Date: 30. October 2023 | Valid until: 30. October 2025

Verified by:

Julie Marie Vejsgaard Larsen, LCA & EPD Consultant

Verification based on report: Validation of CO₂ calculation of 9 categories of Kompan product line, version 1.0, prepared by: Bureau Veritas HSE, Denmark: Julie M. V. Larsen.

Publication date: 30. October 2023

By Bureau Veritas HSE
www.bureauveritas.dk
+45 7731 1000



Sitting Pole

NRO210

* Max fall height | ** Total height | *** Safety surfacing area

* Max fall height | ** Total height

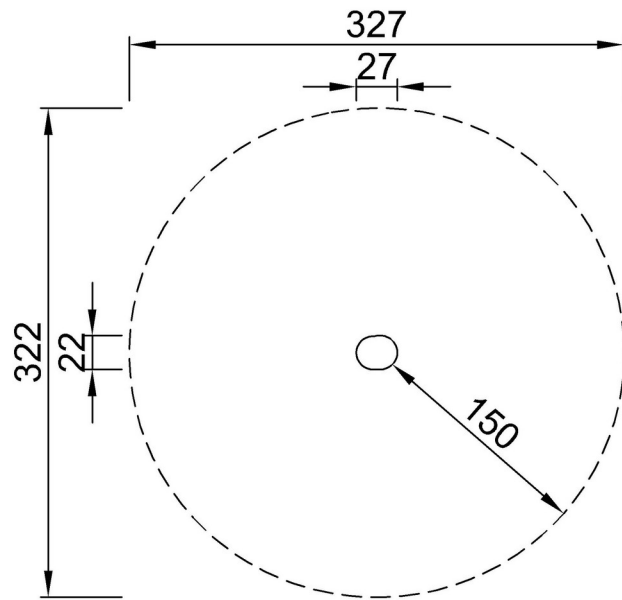

NRO210
*29cm
**29cm
***8.5m²

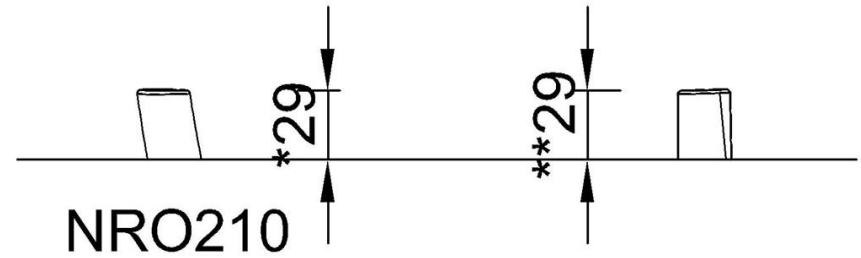

[Click to see TOP VIEW](#)

[Click to see SIDE VIEW](#)