

Orient Express

M241



Item no. M24170-3218P	
General Product Information	
Dimensions LxWxH	122x72x93 cm
Age group	6m+
Play capacity (users)	4
Colour options	●



Wow! Children will delight in a ride on the Orient Express. This playful unit supports social-emotional and physical skills in young children. The intentional design encourages children to stay and play, which provides great fun and developmental benefits. In addition to being a place to sit alone or with friends, the Orient Express spurs stories about train rides,

supporting language skills and story-telling. Sitting with friends stimulates social-emotional development, and friendship skills. The small holes invite exploration and provide children with opportunities to play peek-a-boo and other games. Young children will also enjoy moving around the train, and for younger children, pulling themselves up to stand will support

physical development.



Orient Express

M241



Theme

Cognitive: suggests a theme and supports dramatic play, which stimulates language and communication skills.



Bench

Social-Emotional: gathering, cooperating or taking a break from play - all train social skills.

Orient Express

M241



Panels of 19mm EcoCore™. EcoCore™ is a highly durable, eco friendly material, which is not only recyclable after use, but also consists of material produced from +95% recycled post consumer material from food packing waste.



The seating area is made of HPL with a thickness 17,8 mm. KOMPAN HPL has high wearing strength to ensure long lifetime in all climates.

Item no. M24170-3218P	
Installation Information	
Max. fall height	35 cm
Safety surfacing area	13.6 m²
Total installation time	3.6
Excavation volume	0.13 m³
Concrete volume	0.00 m³
Footing depth (standard)	32 cm
Shipment weight	103 kg
Anchoring options	In-ground ✓ Surface ✓
Warranty Information	
EcoCore HDPE	Lifetime
HPL seat	15 years
Spare parts guaranteed	10 years



Sustainability Data

M241



Cradle to Gate A1-A3	Total CO ₂ emission	CO ₂ e/kg	Recycled materials
	kg CO ₂ e	kg CO ₂ e/kg	%
M24170-3218P	93.80	1.66	48.80

The overall framework applied for these factors is the Environmental Product Declaration (EPD), which quantifies "environmental information on the life cycle of a product and enable comparisons between products fulfilling the same function" (ISO, 2006). This follows the structure and applies a Life-Cycle Assessment approach to the entire Product stage from raw material through manufacturing (A1-A3))

* Max fall height | ** Total height | *** Safety surfacing area

* Max fall height | ** Total height

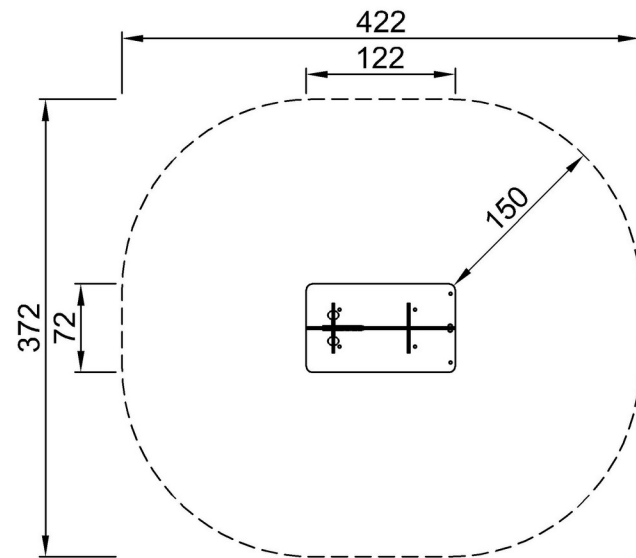

M24170P-xx18
*35cm
**93cm
***13.6m²

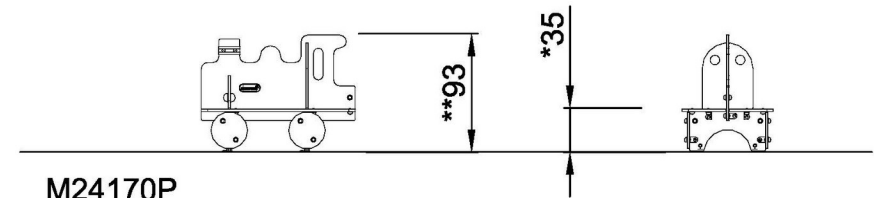

M24170P
1:100

[Click to see TOP VIEW](#)

[Click to see SIDE VIEW](#)