

Crazy Gander

M106



Tummy tickling fun of rocking it out again and again. Crazy Gander is inviting with bright colours and support for young bodies. Universal design supports the back, calf and foot supports, the shelter of the seat sides and the vertical handholds make it accessible and usable for all. Children rock the Crazy Gander using their leg, arm, and core muscles to

coordinate movements and set it into motion. Alternatively, the spring will move when children stem their back into the seat, without using leg muscles. The hand-holds support a relevant grip height for all. Rocking the Crazy Gander supports the senses of balance and space, which are fundamental for body confidence and movement control. The spring's

response to movement builds an understanding of cause-and-effect. It supports logical thinking, a fundamental cognitive skill.

Item no. M10670-01P	
General Product Information	
Dimensions LxWxH	54x83x78 cm
Age group	1+
Play capacity (users)	1
Colour options	

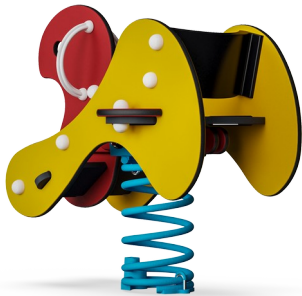

Crazy Gander

M106



Handhold

Physical: opens more hold positions and ensures good grip, necessary for rocking intensely which trains hand and arm muscles.



Foot and back support

Physical: extra back and foot support for children with disabilities. Rocking promotes sense of balance and space. Arms and leg muscles are strengthened.



Theme

Cognitive: suggests a theme and supports dramatic play, which stimulates language and communication skills.



Rocking spring

Physical: response to movements adds to spatial awareness and sense of balance which are fundamental motor skills.

Cognitive: trains the understanding of cause and effect: when I move my body, the spring responds with movement.

Crazy Gander

M106



Panels of 19mm EcoCore™. EcoCore™ is a highly durable, eco-friendly material, which is not only recyclable after use but also consists of a core produced from 100% recycled material.



KOMPAN's springs are manufactured from high-quality spring steel. The springs are cleaned by phosphating before being painted with epoxy primer and polyester powder coating. The springs are fixed by unique anti-pinch fittings for maximum safety and longevity.



The springs are fixed by unique anti-pinch fittings for maximum safety and longevity.

Item no. M10670-01P	
Installation Information	
Max. fall height	60 cm
Safety surfacing area	8.0 m²
Total installation time	3.2
Excavation volume	0.19 m³
Concrete volume	0.00 m³
Footing depth (standard)	45 cm
Shipment weight	44 kg
Anchoring options	In-ground ✓ Surface ✓
Warranty Information	
EcoCore HDPE	Lifetime
Galvanised Steel	Lifetime
Spare Parts Guarantee	10 years
Springs	5 years

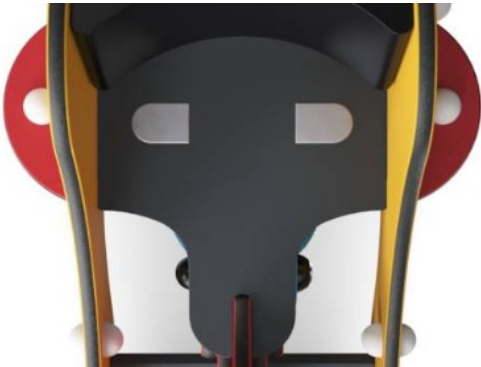

Seat is made of HPL with a thickness of 17.8mm with a very high wearing strength and a unique KOMPAN nonskid surface texture.



Rock wall handholds are made of pressure moulded high-quality nylon (PA6). PA6 has good wearing and impact strength.



Back support is made of PUR. All components retain their properties in high temperature spans. All materials are UV stabilised to a maximum without the use of heavy metal stabilisers.



Sustainability Data

M106

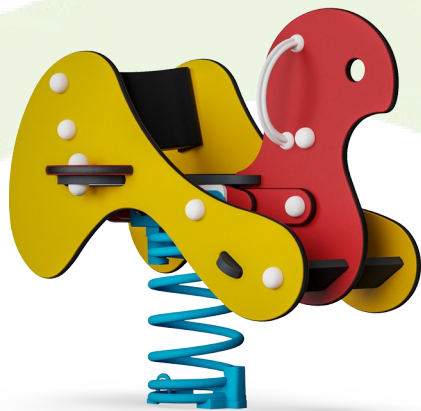

Cradle to Gate A1-A3	Total CO ₂ emission	CO ₂ e/kg	Recycled materials
	kg CO ₂ e	kg CO ₂ e/kg	%
M10670-01P	87.40	2.23	49.40

The overall framework applied for these factors is the Environmental Product Declaration (EPD), which quantifies "environmental information on the life cycle of a product and enable comparisons between products fulfilling the same function" (ISO, 2006). This follows the structure and applies a Life-Cycle Assessment approach to the entire Product stage from raw material through manufacturing (A1-A3))

Kompan A/S
C.F. Tietgens Boulevard 32C
DK-5220 Odense SØ
Denmark



Verification of CO₂ calculation of: Freestanding play equipment



Data version no. 2023-10-05

The CO₂ calculation and data are in compliance with the principles of a carbon footprint impact according to the GHG protocol (Greenhouse Gas Protocol), Scope 3, cradle to gate related to all individual components in the product category: "Freestanding play equipment" represented by item no.: GXY916012-3417.

(Scope 3 emissions include emission sources in the upstream and downstream value chain).

Date: 30. October 2023 | Valid until: 30. October 2025
Verified by:

Julie Marie Vejsgaard Larsen, LCA & EPD Consultant

Verification based on report: Validation of CO₂ calculation of 9 categories of Kompan product line, version 1.0, prepared by: Bureau Veritas HSE, Denmark: Julie M. V. Larsen.

Publication date: 30. October 2023

By Bureau Veritas HSE
www.bureauveritas.dk
+45 7731 1000



Crazy Gander

M106

* Max fall height | ** Total height | *** Safety surfacing area

* Max fall height | ** Total height

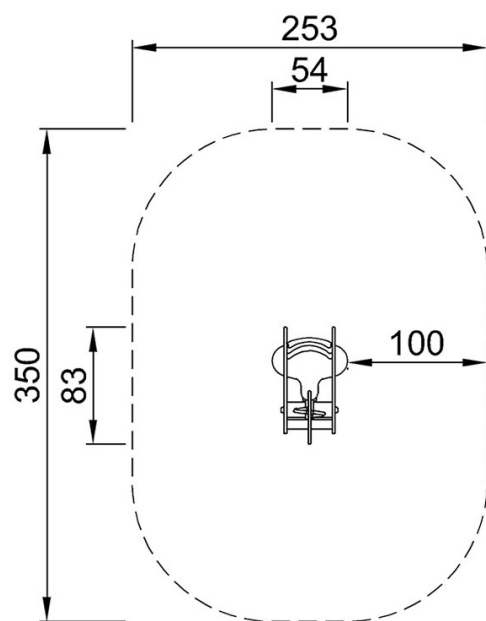

M10670P

*60cm

**78cm

***8m²

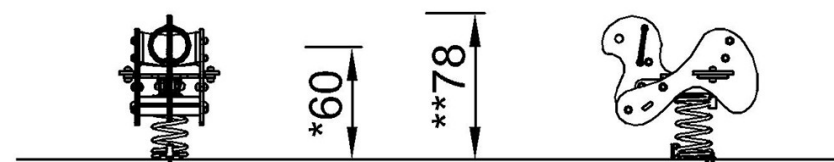

M10670

[Click to see TOP VIEW](#)

[Click to see SIDE VIEW](#)