

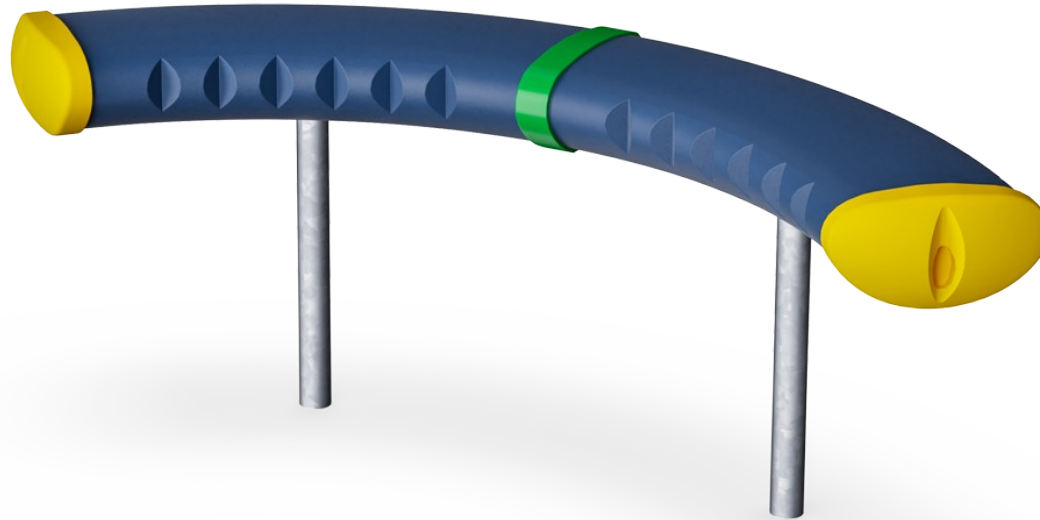

Crescent 60

FRE3011



| | |
|-----------------------------|---|
| Item no. FRE3011-3417 | |
| General Product Information | |
| Dimensions LxWxH | 4'2"x3'7"x2'0" |
| Age group | 3+ |
| Play capacity (users) | - |
| Color options |  |



The Crescent is a backless bench with a contemporary architectural style.

Crescent 60

FRE3011

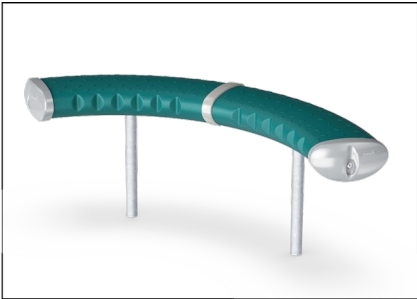

The steel surfaces are hot-dip galvanized inside and outside with lead-free zinc. The galvanization has excellent corrosion resistance in outside environments and requires minimal maintenance.

KOMPAN GreenLine versions are designed with the most environmentally friendly materials with the lowest possible CO2e emission factor such as EcoCore™ panels of 100% post-consumer recycled ocean waste.

| | |
|--------------------------|--------------------------|
| Item no. FRE3011-3417 | |
| Installation Information | |
| Max. fall height | 0'0" |
| Safety surfacing area | 0ft² |
| Total installation time | 1.9 |
| Excavation volume | 0.38yd³ |
| Concrete volume | 0.13yd³ |
| Footing depth (standard) | 2'0" |
| Shipment weight | 66lbs |
| Anchoring options | In-ground ✓ Surface ✓ |
| Warranty Information | |
| Hollow PE Parts | 10 Years |
| Hot dip galvanized steel | Lifetime |
| Spare Parts Availability | 10 Years |

Sustainability Data

FRE3011

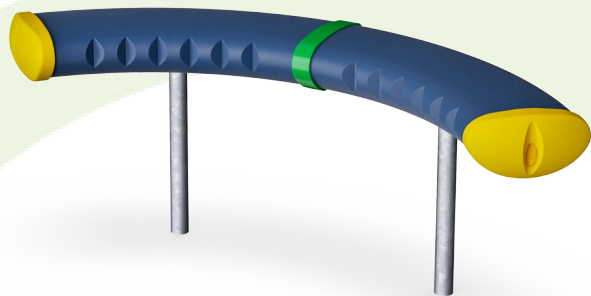

| Cradle to Gate A1-A3 | Total CO ₂ emission | CO ₂ e/kg | Recycled materials |
|----------------------|--------------------------------|-------------------------|--------------------|
| | kg CO ₂ e | kg CO ₂ e/kg | % |
| FRE3011-3417 | 73.10 | 2.28 | 34.60 |

The overall framework applied for these factors is the Environmental Product Declaration (EPD), which quantifies "environmental information on the life cycle of a product and enable comparisons between products fulfilling the same function" (ISO, 2006). This follows the structure and applies a Life-Cycle Assessment approach to the entire Product stage from raw material through manufacturing (A1-A3))

Kompan A/S
C.F. Tietgens Boulevard 32C
DK-5220 Odense SØ
Denmark



Verification of CO₂ calculation of:
Park



Data version no. 2023-10-05

The CO₂ calculation and data are in compliance with the principles of a carbon footprint impact according to the GHG protocol (Greenhouse Gas Protocol), Scope 3, cradle to gate related to all individual components in the product category: "Park" represented by item no.: PAR4070-0001.

(Scope 3 emissions include emission sources in the upstream and downstream value chain).

Date: 30. October 2023 | Valid until: 30. October 2025
Verified by:

Julie Marie Vejsgaard Larsen, LCA & EPD Consultant

Verification based on report: Validation of CO₂ calculation of 9 categories of Kompan product line, version 1.0, prepared by: Bureau Veritas HSE, Denmark: Julie M. V. Larsen.

Publication date: 30. October 2023

By Bureau Veritas HSE
www.bureauveritas.dk
+45 7731 1000



Crescent 60

FRE3011

* Max fall height | ** Total height | *** Safety surfacing area

* Max fall height | ** Total height

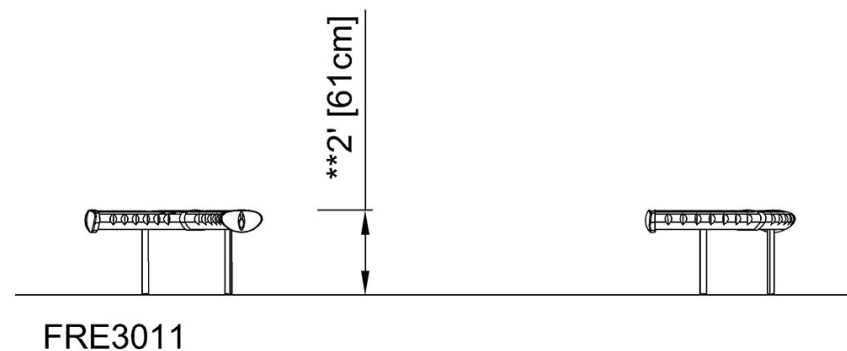
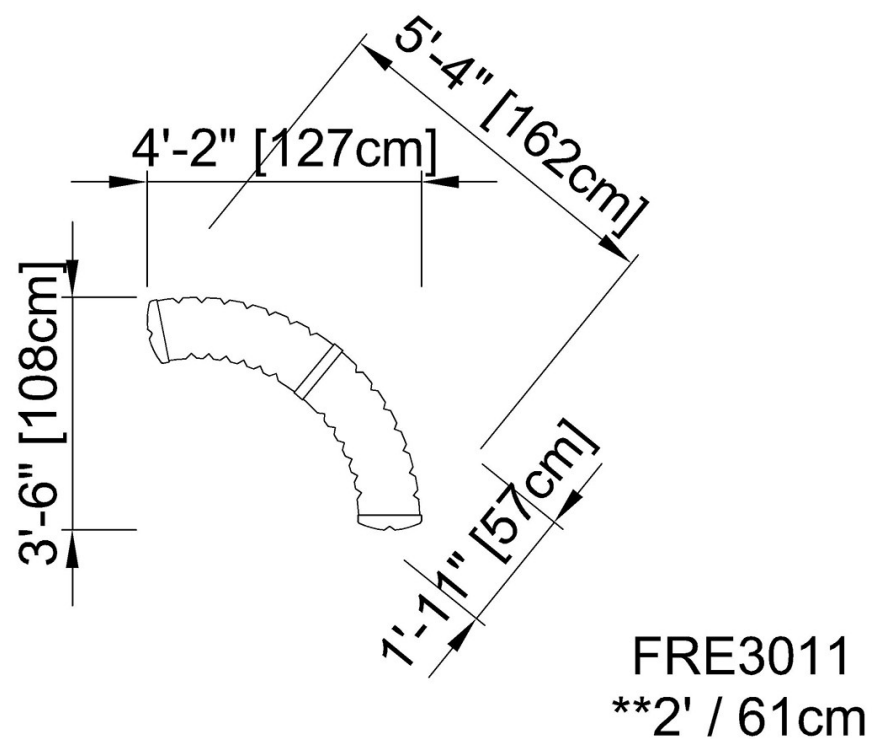

[Click to see TOP VIEW](#)

[Click to see SIDE VIEW](#)