

Donkey Ride

NAT101



The nature range is made from beautiful pinewood. Timber play items are always a great addition to any playground, providing a rich and inviting new material for children to touch, feel and play with

| | |
|-----------------------------|-------------|
| Item no. NAT101-0412 | |
| General Product Information | |
| Dimensions LxWxH | 44x81x67 cm |
| Age group | 2+ |
| Play capacity (users) | 1 |
| Colour options | |



Donkey Ride

NAT101



Handhold

Physical: opens more hold positions and ensures good grip, necessary for rocking intensely which trains hand and arm muscles.



Rocking spring

Physical: response to movements adds to spatial awareness and sense of balance which are fundamental motor skills.

Cognitive: trains the understanding of cause and effect: when I move my body, the spring responds with movement.



Foot support

Physical: the footrest supports intensive rocking, which stimulates the senses of balance and space, fundamental for managing the world securely.

Donkey Ride

NAT101



Posts and boards are made of pine wood from sustainable European sources. The wood is pressure impregnated Class 3 with Tanalith E. On request it can be supplied as FSC® Certified (FSC® C004450).

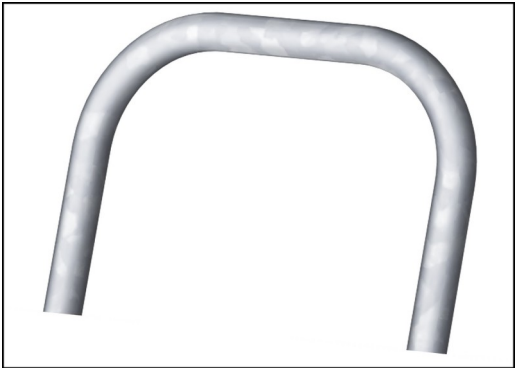

The steel surfaces are hot-dip galvanised inside and outside with lead-free zinc. The galvanisation has excellent corrosion resistance in outside environments and requires low maintenance.



KOMPAN's springs are manufactured from high-quality spring steel. The springs are cleaned by phosphating before being painted with epoxy primer and polyester powder coating. The springs are fixed by unique anti-pinch fittings for maximum safety and longevity.



The teardrop handle shape and diameter has been designed to be the optimal fitting for older children. Finishing has been achieved with special thermoplastic polyurethane (TPU) rubber surface, making it an appealing surface to touch.

| Item no. NAT101-0412 | |
|--------------------------|--------------------------|
| Installation Information | |
| Max. fall height | 60 cm |
| Safety surfacing area | 7.5 m² |
| Total installation time | 2.0 |
| Excavation volume | 0.21 m³ |
| Concrete volume | 0.00 m³ |
| Footing depth (standard) | 43 cm |
| Shipment weight | 37 kg |
| Anchoring options | In-ground ✓ Surface ✓ |
| Warranty Information | |
| Handle | 10 years |
| Galvanised Steel | Lifetime |
| Pinewood | 10 years |
| Spare Parts Guarantee | 10 years |
| Springs | 5 years |



Sustainability Data

NAT101



| Cradle to Gate A1-A3 | Total CO ₂ emission | CO ₂ e/kg | Recycled materials |
|----------------------|--------------------------------|-------------------------|--------------------|
| | kg CO ₂ e | kg CO ₂ e/kg | % |
| NAT101-0412 | 80.40 | 2.46 | 38.00 |

The overall framework applied for these factors is the Environmental Product Declaration (EPD), which quantifies "environmental information on the life cycle of a product and enable comparisons between products fulfilling the same function" (ISO, 2006). This follows the structure and applies a Life-Cycle Assessment approach to the entire Product stage from raw material through manufacturing (A1-A3))

Kompan A/S
C.F. Tietgens Boulevard 32C
DK-5220 Odense SØ
Denmark



Verification of CO₂ calculation of: Nature play



Data version no. 2023-10-05

The CO₂ calculation and data are in compliance with the principles of a carbon footprint impact according to the GHG protocol (Greenhouse Gas Protocol), Scope 3, cradle to gate related to all individual components in the product category: "Nature play" represented by item no.: NR0409-0621.

(Scope 3 emissions include emission sources in the upstream and downstream value chain).

Date: 30. October 2023 | Valid until: 30. October 2025
Verified by:

Julie Marie Vejsgaard Larsen, LCA & EPD Consultant

Verification based on report: Validation of CO₂ calculation of 9 categories of Kompan product line, version 1.0, prepared by: Bureau Veritas HSE, Denmark: Julie M. V. Larsen.

Publication date: 30. October 2023

By Bureau Veritas HSE
www.bureauveritas.dk
+45 7731 1000



Donkey Ride

NAT101

* Max fall height | ** Total height | *** Safety surfacing area

* Max fall height | ** Total height

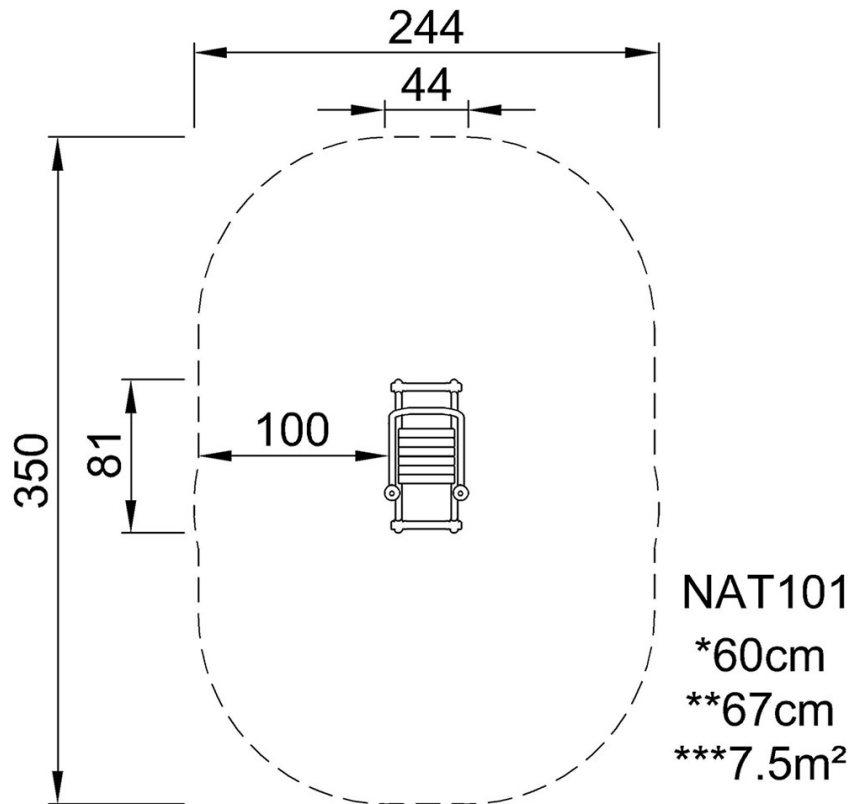

[Click to see TOP VIEW](#)

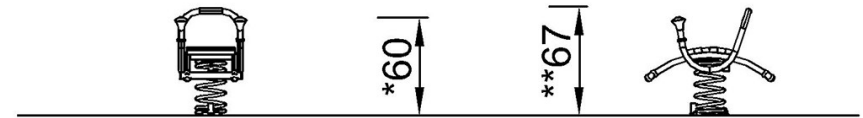

NAT101

[Click to see SIDE VIEW](#)